

# HARRAH'S NORTH KANSAS CITY

## Meeting Facilities Map

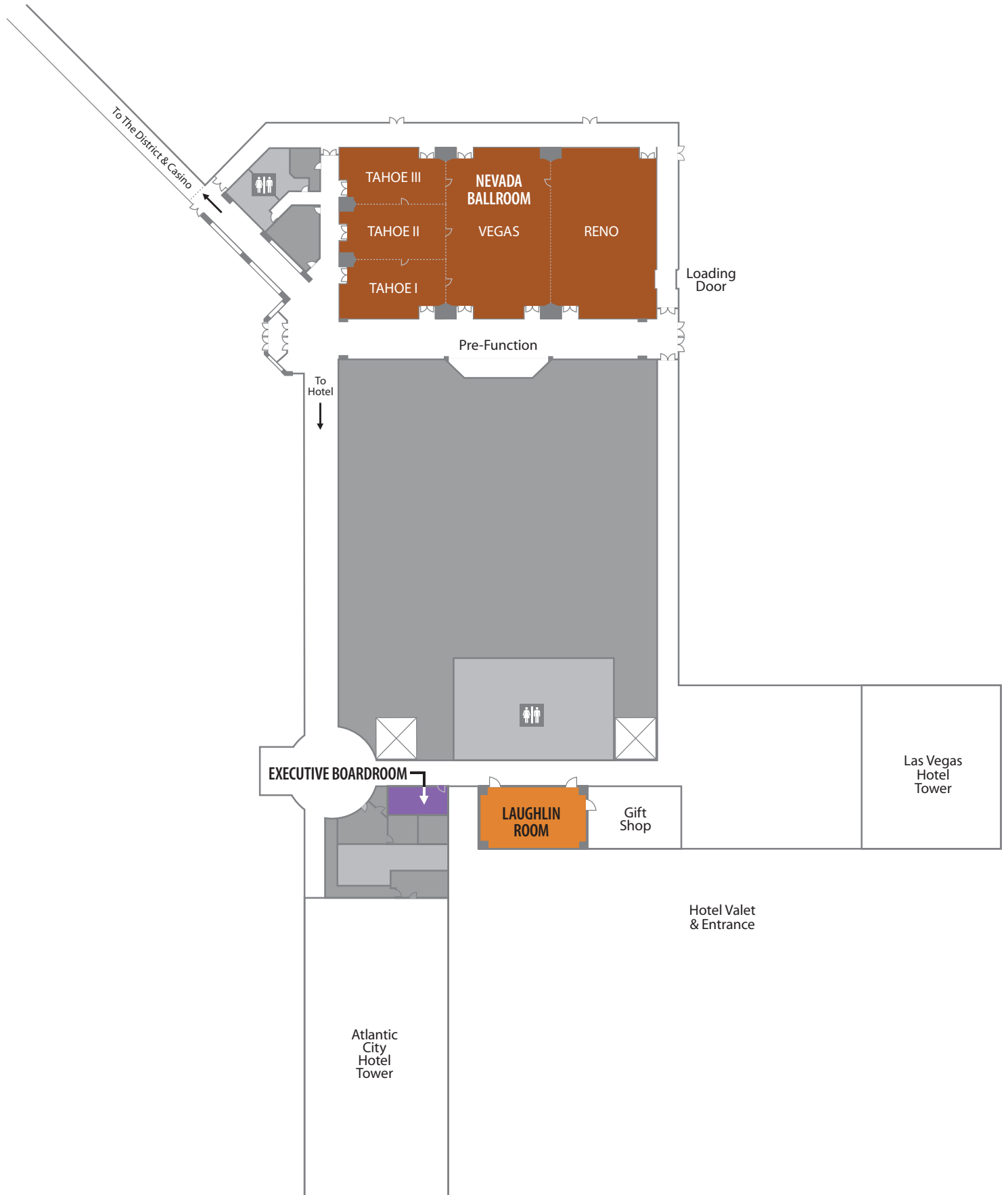



## HOTEL MEETING ROOMS

### Capacities and Dimensions

ROOM	SQ.FT	WIDTH	LENGTH	CEILING	CLASSROOM	THEATER	RECEPTION	BANQUET	EXHIBITS	U-SHAPE	H-SQUARE	CONF.
<b>Nevada Ballroom</b>	<b>9,792</b>	<b>136</b>	<b>72</b>	<b>14'</b>	<b>500</b>	<b>900</b>	<b>800</b>	<b>550</b>	<b>47</b>	—	—	—
Vegas Room	3,240	45	72	14'	150	270	250	180	—	70	—	—
Reno Room	3,240	45	72	14'	150	270	250	180	—	70	—	—
Tahoe I – III	3,240	45	72	14'	150	270	250	180	—	70	—	—
Tahoe I	1,080	45	24	14'	45	70	60	50	—	25	—	30
Tahoe II	1,080	45	24	14'	45	70	60	50	—	25	—	30
Tahoe III	1,080	45	24	14'	45	70	60	50	—	25	—	30
<b>Laughlin Ballroom</b>	<b>728</b>	<b>26</b>	<b>28</b>	<b>10'</b>	<b>25</b>	<b>40</b>	—	<b>24</b>	—	<b>18</b>	—	<b>22</b>
Executive Boardroom	416	13	32	8'	—	—	—	—	—	—	—	18

## SPECIAL VENUES

### Capacities and Dimensions

ROOM	SQ.FT	WIDTH	LENGTH	CEILING	CLASSROOM	THEATER	RECEPTION	BANQUET	EXHIBITS	U-SHAPE	H-SQUARE	CONF.
Voodoo Lounge	22,910	—	—	42.2	70	764	500	100	—	25	—	25