

# WATERFRONT CONFERENCE CENTER

## Meeting Facilities Maps

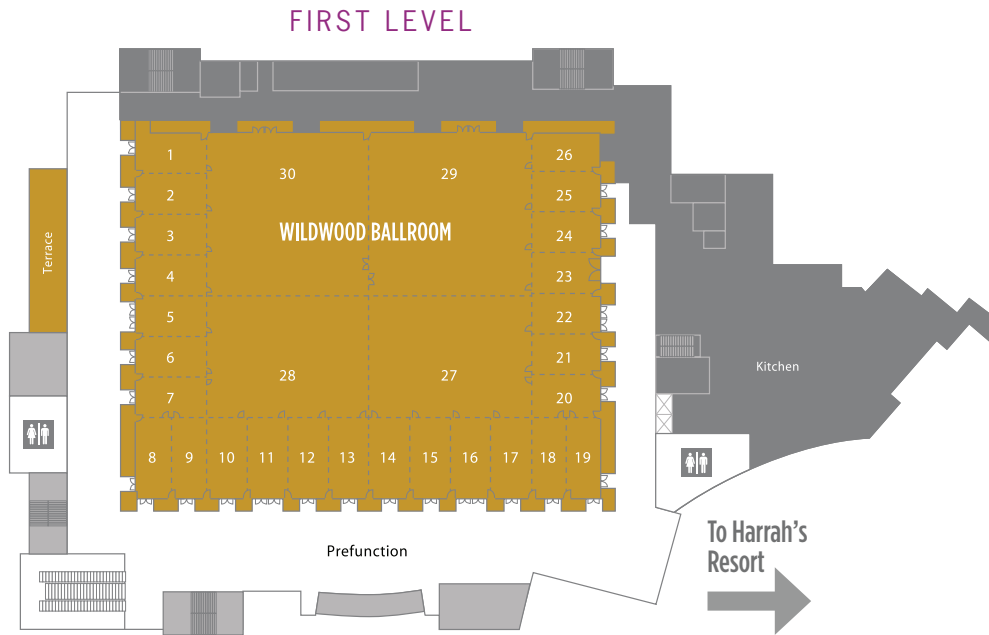

# HARRAH'S RESORT MEETING ROOMS

## Meeting Facilities Map

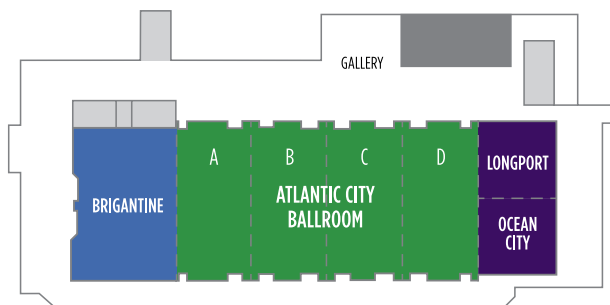

# WATERFRONT CONFERENCE CENTER

## Capacities and Dimensions

MEETING ROOMS	SQ. FT.	WIDTH	LENGTH	CEILING	CLASSROOM	THEATER	RECEPTION	BANQUET	EXHIBIT	CONFERENCE
<b>Wildwood Ballroom</b>	<b>49,447</b>	<b>251'</b>	<b>197'</b>	<b>27' 6"</b>	<b>3,410</b>	<b>5,204</b>	<b>5,494</b>	<b>4,120</b>	<b>309</b>	<b>1,648</b>
Wildwood 1	845	22'	37' 6"	27' 6"	58	88	93	70	5	28
Wildwood 2	816	22'	37' 6"	27' 6"	56	85	90	68	5	27
Wildwood 3	816	22'	37' 6"	27' 6"	56	85	90	68	5	27
Wildwood 4	816	22'	37' 6"	27' 6"	56	85	90	68	5	27
Wildwood 5	816	22'	37' 6"	27' 6"	56	85	90	68	5	27
Wildwood 6	816	22'	37' 6"	27' 6"	56	85	90	68	5	27
Wildwood 7	816	22'	37' 6"	27' 6"	56	85	90	68	5	27
Wildwood 8	804	18' 9"	43' 6"	27' 6"	55	84	89	67	5	26
Wildwood 9	812	18' 9"	43' 6"	27' 6"	56	85	90	67	5	27
Wildwood 10	948	22'	43' 6"	27' 6"	65	99	105	79	5	31
Wildwood 11	948	22'	43' 6"	27' 6"	65	99	105	79	5	31
Wildwood 12	948	22'	43' 6"	27' 6"	65	99	105	79	5	31
Wildwood 13	948	22'	43' 6"	27' 6"	65	99	105	79	5	31
Wildwood 14	948	22'	43' 6"	27' 6"	65	99	105	79	5	31
Wildwood 15	948	22'	43' 6"	27' 6"	65	99	105	79	5	31
Wildwood 16	948	22'	43' 6"	27' 6"	65	99	105	79	5	31
Wildwood 17	948	22'	43' 6"	27' 6"	65	99	105	79	5	31
Wildwood 18	812	18' 9"	43' 6"	27' 6"	56	85	90	67	5	27
Wildwood 19	804	18' 9"	43' 6"	27' 6"	55	84	89	67	5	26
Wildwood 20	817	22'	37' 6"	27' 6"	56	85	90	68	5	27
Wildwood 21	817	22'	37' 6"	27' 6"	56	85	90	68	5	27
Wildwood 22	817	22'	37' 6"	27' 6"	56	85	90	68	5	27
Wildwood 23	817	22'	37' 6"	27' 6"	56	85	90	68	5	27
Wildwood 24	817	22'	37' 6"	27' 6"	56	85	90	68	5	27
Wildwood 25	817	22'	37' 6"	27' 6"	56	85	90	68	5	27
Wildwood 26	801	22'	37' 6"	27' 6"	55	84	89	66	5	26
Wildwood 27	6,738	88'	76' 8"	27' 6"	464	709	749	561	42	225
Wildwood 28	6,738	88'	76' 8"	27' 6"	464	709	749	561	42	225
Wildwood 29	6,738	88'	76' 8"	27' 6"	464	709	749	561	42	225
Wildwood 30	6,738	88'	76' 8"	27' 6"	464	709	749	561	42	225
Prefunction	25,743	—	—	27' 6"	—	—	2,860	—	—	—
<b>Terrace</b>	<b>1,713</b>	<b>88'</b>	<b>19'</b>	—	—	—	<b>190</b>	—	—	—

# WATERFRONT CONFERENCE CENTER

## Capacities and Dimensions

MEETING ROOMS	SQ. FT.	WIDTH	LENGTH	CEILING	CLASSROOM	THEATER	RECEPTION	BANQUET	EXHIBIT	CONFERENCE
<b>Avalon Ballroom</b>	<b>49,447</b>	<b>251'</b>	<b>197'</b>	<b>23' 6"</b>	<b>3,410</b>	<b>5,204</b>	<b>5,494</b>	<b>4,120</b>	<b>309</b>	<b>1,648</b>
Avalon 1	836	22'	37' 6"	23' 6"	57	88	92	69	5	27
Avalon 2	816	22'	37' 6"	23' 6"	56	85	90	68	5	27
Avalon 3	816	22'	37' 6"	23' 6"	56	85	90	68	5	27
Avalon 4	816	22'	37' 6"	23' 6"	56	85	90	68	5	27
Avalon 5	816	22'	37' 6"	23' 6"	56	85	90	68	5	27
Avalon 6	816	22'	37' 6"	23' 6"	56	85	90	68	5	27
Avalon 7	816	22'	37' 6"	23' 6"	56	85	90	68	5	27
Avalon 8	804	18' 9"	43' 6"	23' 6"	55	84	89	67	5	26
Avalon 9	812	18' 9"	43' 6"	23' 6"	56	85	90	67	5	27
Avalon 10	948	22'	43' 6"	23' 6"	65	99	105	79	5	31
Avalon 11	948	22'	43' 6"	23' 6"	65	99	105	79	5	31
Avalon 12	948	22'	43' 6"	23' 6"	65	99	105	79	5	31
Avalon 13	948	22'	43' 6"	23' 6"	65	99	105	79	5	31
Avalon 14	948	22'	43' 6"	23' 6"	65	99	105	79	5	31
Avalon 15	948	22'	43' 6"	23' 6"	65	99	105	79	5	31
Avalon 16	948	22'	43' 6"	23' 6"	65	99	105	79	5	31
Avalon 17	948	22'	43' 6"	23' 6"	65	99	105	79	5	31
Avalon 18	814	18' 9"	43' 6"	23' 6"	56	85	90	67	5	27
Avalon 19	803	18' 9"	43' 6"	23' 6"	55	84	89	66	5	26
Avalon 20	817	22'	37' 6"	23' 6"	56	85	90	68	5	27
Avalon 21	817	22'	37' 6"	23' 6"	56	85	90	68	5	27
Avalon 22	817	22'	37' 6"	23' 6"	56	85	90	68	5	27
Avalon 23	817	22'	37' 6"	23' 6"	56	85	90	68	5	27
Avalon 24	817	22'	37' 6"	23' 6"	56	85	90	68	5	27
Avalon 25	817	22'	37' 6"	23' 6"	56	85	90	68	5	27
Avalon 26	801	22'	37' 6"	23' 6"	55	84	89	66	5	26
Avalon 27	6,738	88'	76' 8"	23' 6"	464	709	749	561	42	225
Avalon 28	6,738	88'	76' 8"	23' 6"	464	709	749	561	42	225
Avalon 29	6,738	88'	76' 8"	23' 6"	464	709	749	561	42	225
Avalon 30	6,738	88'	76' 8"	23' 6"	464	709	749	561	42	225
Prefunction	26,010	—	—	23' 6"	—	—	2,890	—	—	—
<b>Terrace</b>	<b>1,746</b>	<b>88'</b>	<b>19'</b>	—	—	—	<b>194</b>	—	—	—

## HARRAH'S RESORT MEETING ROOMS

### Capacities and Dimensions

MEETING ROOMS	SQ. FT.	WIDTH	LENGTH	CEILING	CLASSROOM	THEATER	RECEPTION	BANQUET	EXHIBIT
<b>Atlantic City Ballroom</b>	<b>13,200</b>	<b>163'</b>	<b>81'</b>	<b>10'</b>	<b>650</b>	<b>1,200</b>	<b>1,300</b>	<b>800</b>	<b>100</b>
A	3,078	38'	81'	10'	150	300	300	150	25
B	3,402	42'	81'	10'	175	300	300	200	25
C	3,402	42'	81'	10'	175	300	300	200	25
D	3,321	41'	81'	10'	175	300	300	200	25
<b>Gallery</b>	<b>4,394</b>	<b>20'</b>	<b>163'</b>	<b>11'</b>	—	—	<b>500</b>	—	—
<b>Brigantine</b>	<b>4,144</b>	<b>56'</b>	<b>74'</b>	<b>11'6"</b>	<b>150</b>	<b>225</b>	<b>350</b>	<b>250</b>	<b>27</b>
<b>Ocean City &amp; Longport</b>	<b>2,064</b>	<b>60'</b>	<b>50'</b>	<b>8'10"</b>	<b>120</b>	<b>160</b>	<b>150</b>	<b>120</b>	<b>12</b>
Ocean City	1,161	50'	30'	10'	40	100	80	50	8
Longport	903	50'	30'	10'	40	60	60	50	7

## SPECIAL VENUES

### Capacities and Dimensions

<b>The Concert Venue</b>	—	—	—	—	—	<b>1,200</b>	—	—	—
<b>Pool Deck</b>	<b>172,000</b>	—	—	—	—	—	<b>2,000</b>	—	—
<b>Viking Cooking School</b>	—	—	—	—	<b>18</b>	—	<b>32</b>	—	—



# HARRAH'S RESORT ATLANTIC CITY

## Property Map

### First Level

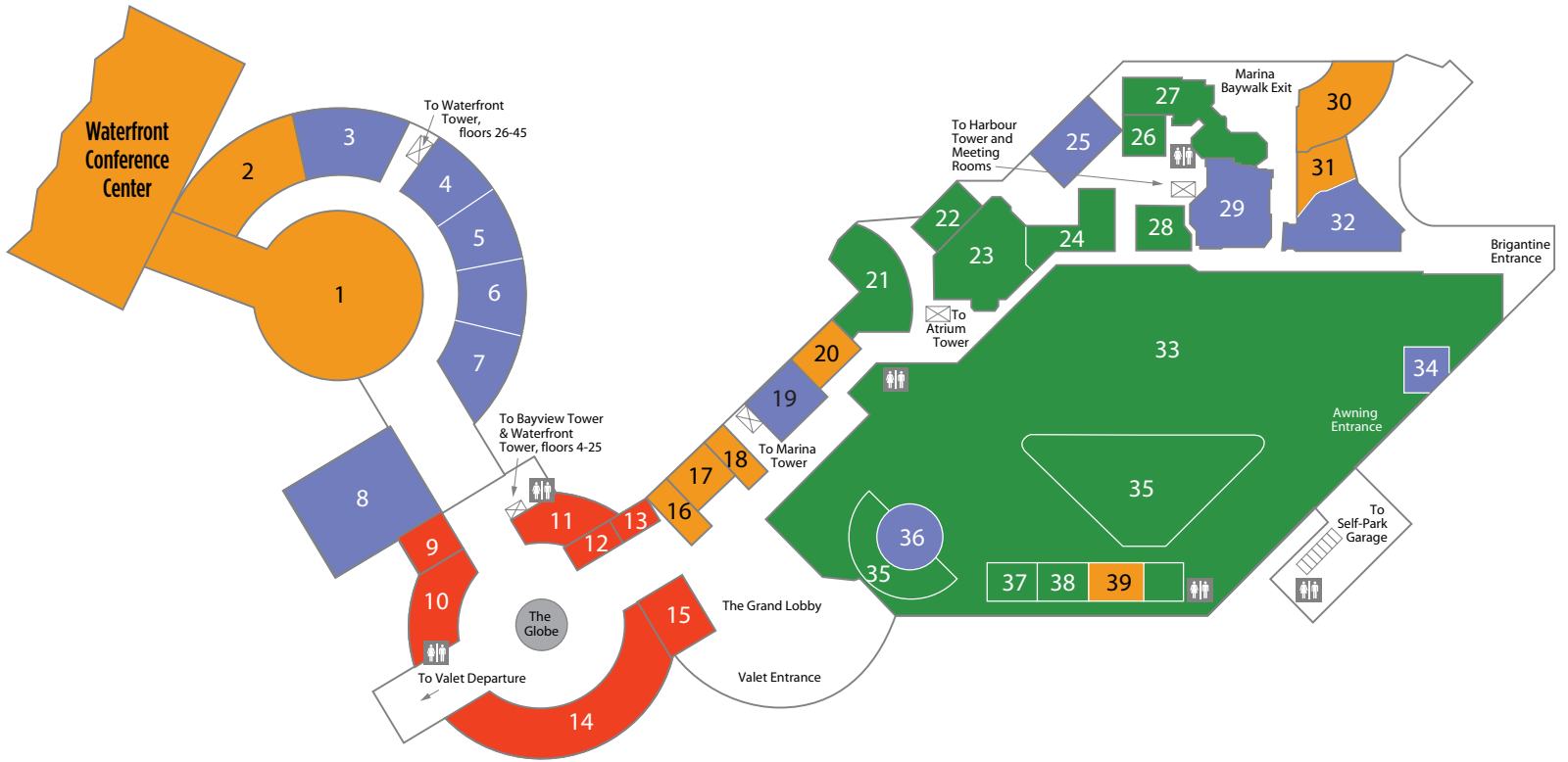

### Second Level

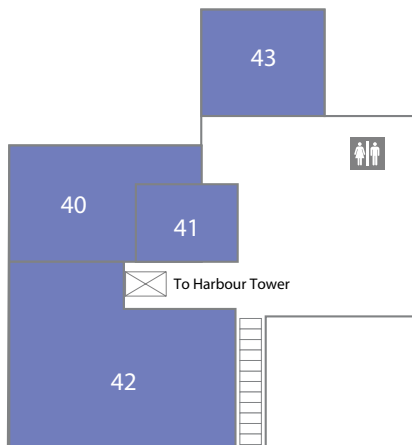

### Third Level

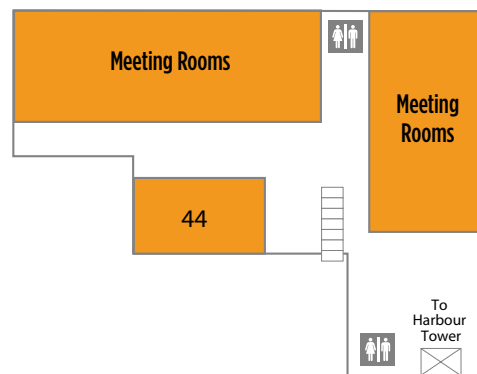



## RESTAURANTS/BARS

3. Sammy D's Restaurant & Bar
4. Sack O' Subs
5. Walt's Original Primo Pizza
6. Ben & Jerry's
7. Philly Pretzel Factory
8. Waterfront Buffet
19. Café Tazza
25. McCormick & Schmick's  
Seafood Restaurant
29. Eden Lounge
32. Bill's Bar & Burger
34. Video Poker Bar
36. Xhibition Bar
40. The Steakhouse
41. Bluepoint Raw Bar
42. Martorano's
43. Dos Caminos

## CASINO

21. Slots
22. Seven Stars® Lounge
23. Diamond Cove
24. Keno
26. Racebook
27. Poker Room
28. Total Rewards
33. Slots

35. Table Games
37. Main Cashier
38. Casino Credit

## SHOPPING

9. Studio Shoes
10. Studio
11. Top Drawer
12. Destinations
13. Pandora
14. Viking Cooking School & Retail Store
15. Park Place Jewelers

## FACILITY

1. The Pool
2. Elizabeth Arden Red Door Spa
14. Viking Cooking School & Retail Store
16. Concierge
17. Front Desk
18. Bell Desk
20. VIP Check-In
30. The Concert Venue
31. Diamond Lounge
39. Security
44. Fitness Center