

DOLCE LA HULPE BRUSSELS

Located in the heart of the Sonian forest only 15 km from Brussels city center, Dolce La Hulpe Brussels is a 4* star conference hotel and spa resort.

Guest Rooms & Suites

All of our 264 rooms and suites offer a stunning view on the Sonian forest, an elegant and comfortable design and are equipped with modern technology.

Bedrooms

- 141 Superior Rooms
- 41 Deluxe Rooms
- 70 Executive Rooms
- 11 Junior Suites
- 1 Sequoia Suite
- 5 Rooms accessible with Wheelchair
- Connecting Rooms for Families

Room facilities

- King Size bed – twin beds
- Flat screen television
- Large work desk
- Free wireless Internet
- Minibar
- Bathrooms with rain shower or bath
- Coffee & tea making facilities

Restaurant and Bars

- "Argan" buffet restaurant
- "Brasserie 135" restaurant with terrace, offering conscious food made from local products
- "Badian" lobby bar, with terrace
- "Oak Bar" lounge night bar

Activities

- "Spa Cinq Mondes" renowned expert in world spa treatments
- Indoor pool and sauna
- Fitness centre
- Hammam
- Outdoor tennis courts
- Jogging
- Biking
- Wellness parcours
- The Cube www.destinationcube.com
- Theme Nights
- More than 50 activities dedicated to team building
- Château de La Hulpe
- Folon Foundation
- Golf Courses nearby

Meeting & Events

With its state-of-the-art technology supported by an onsite A/V team and delicious food served at the Nourishment Hub, our ultra-modern 4500m² - 48.500 sq ft Conference Centre gathers all the comfort, professionalism and tranquillity which are necessary to create a perfect venue for productive meetings.

Capacity chart

- 4500 sqm meeting space - 4500m² - 48 000 sq ft
- More than 40 flexible meeting rooms
- 2 auditoria seating 150 and 500 seats respectively
- The Academy including a private auditorium (36 seats) and 3 breakout rooms



Meeting rooms / Seating capacities

Meeting Room	Total m ²	Total sq ft	Measures	Ceiling Height	Ceiling Height ft	Classroom	Theatre	Banquet 10	Reception	Boardroom	U-Shape	H-Square	Cabaret
EXCLUSIVE SPACE - THE ACADEMY													
	424	1.391											
Auditorium (First floor)**	108	354	13 x 8	3,3	10,8	36	-	-	-	-	-	-	-
Breakout (First floor)**	31	102	8.8 x 3.5	3,3	10,8	-	-	-	-	10	-	-	-
Breakout (First floor)**	30	98	8.6 x 3.5	3,3	10,8	-	-	-	-	14	-	-	-
Breakout (Ground floor)**	17	58	3.7 x 4.7	2,6	8,5	-	-	-	-	12	-	-	-
AUDITORIUMS													
Canopée**	495	1.624	-	-	-	500	500	-	-	-	-	-	-
Baobab	354	1.161	-	-	-	150	-	-	-	-	-	-	-
MEETING ROOMS (GROUND FLOOR)													
Amarante	112	367	10.6 x 10.6	3,3	10,8	40	80	-	-	20	26	32	32
Bois dentelle	93	305	8.8 x 10.6	3,3	10,8	40	60	-	-	16	24	32	30
Cherry	219	718	25.2 x 8	3,3	10,8	80	132	-	-	52	28	44	77
Cherry 1	63	206	7.3 x 8	3,3	10,8	22	36	-	-	16	20	20	21
Cherry 2	113	370	10.6 x 7.9	3,3	10,8	36	60	-	-	20	18	24	35
Cherry 3*	43	141	7.3 x 8	3,3	10,8	16	28	-	-	12	12	14	14
Cocobolo	259	850	24.4 x 10.6	3,3	10,8	130	180	-	-	46	52	60	80
Cocobolo 1	112	367	10.6 x 10.6	3,3	10,8	40	80	-	-	16	26	32	36
Cocobolo 2	74	242	7 x 10.6	3,3	10,8	24	50	-	-	16	16	24	24
Cocobolo 3	74	242	7 x 10.6	3,3	10,8	24	50	-	-	16	16	24	24
Delfino	55	180	10.6 x 5.2	3,3	10,8	16	35	-	-	20	18	20	-
Ebene	55	180	10.6 x 5.2	3,3	10,8	16	35	-	-	20	18	20	-
E-coffee	36	118	7 x 5.2	2,7	8,8	-	-	-	45	-	-	-	-
Flamboyant	112	367	10.6 x 10.6	3,3	10,8	40	80	-	-	20	26	32	36
Ginko	170	557	16 x 10.6	3,3	10,8	80	120	-	-	30	38	48	60
MEETING ROOMS (FIRST FLOOR)													
Redwood**	750	2.460	39.6 x 18.9	3,3	10,8	300	600	570	625	78	114	128	318
Redwood 1**	169	554	11.6 x 15.4	3,3	10,8	70	120	110	140	-	34	44	60
Redwood 2**	162	531	10.8 x 15.4	3,3	10,8	70	120	110	140	-	36	46	60
Redwood 3**	258	846	16.9 x 15.4	3,3	10,8	120	180	200	215	-	52	60	80
Teck	170	557	16 x 10.6	3,3	10,8	80	120	-	-	30	38	48	60
Imbuia	170	557	16 x 10.6	3,3	10,8	80	120	-	-	30	38	48	60
Palissandre	112	367	10.6 x 10.6	3,3	10,8	40	80	-	-	20	26	32	36
Mahogany	112	367	10.6 x 10.6	3,3	10,8	40	80	-	-	24	26	32	36
Snakewood	93	305	8.8 x 10.6	3,3	10,8	40	60	-	-	16	24	32	30
Jatoba	93	305	8.8 x 10.6	3,3	10,8	40	60	-	-	18	24	32	30
Kawi	74	242	7 x 10.6	3,3	10,8	24	50	-	-	16	16	24	24
Rosewood	74	242	7 x 10.6	3,3	10,8	24	50	-	-	16	16	24	24
Mangrove 1	36	118	7 x 5.2	3,3	10,8	12	26	-	-	12	12	14	-
Mangrove 2	40	131	7.6 x 5.2	3,3	10,8	12	26	-	-	12	12	14	-
Mangrove 3	46	151	8.9 x 5.2	3,3	10,8	16	26	-	-	12	14	16	-
Mangrove 4	55	180	10.6 x 5.2	3,3	10,8	16	35	-	-	18	18	20	-
BREAKOUT ROOMS (Oasis Floor)													
Pomegranate	66	216	9.4 x 7	2,5	8,2	24	40	-	-	16	20	24	24
Tamarillo	65	213	9.4 x 6.9	2,5	8,2	24	36	-	-	16	16	20	24
Pitaya	64	209	8.8 x 7.2	2,5	8,2	24	36	-	-	16	20	24	18
Acerola*	56	183	9.7 x 5.8	2,6	8,5	20	42	-	-	16	20	24	18
Carambole	51	167	9.7 x 5.2	2,5	8,2	16	30	-	-	16	18	22	18
Fig	51	167	9.7 x 5.3	2,6	8,5	16	30	-	-	16	16	20	18
Guava	51	167	9.7 x 5.3	2,6	8,5	16	30	-	-	16	16	20	18
Kumquat	51	167	9.7 x 5.2	2,6	8,5	16	30	-	-	16	16	20	18
Kiwano	51	167	9.7 x 5.3	2,6	8,5	16	30	-	-	16	16	20	18
Litchi	51	167	9.7 x 5.2	2,6	8,5	16	30	-	-	16	16	20	18
Mango	51	167	9.7 x 5.3	2,6	8,5	16	30	-	-	16	16	20	18
Ramboutan	51	167	7 x 7.3	2,5	8,5	16	30	-	-	16	16	20	24

*without daylight

** outside of conference centre

Floor Plans

GROUND FLOOR

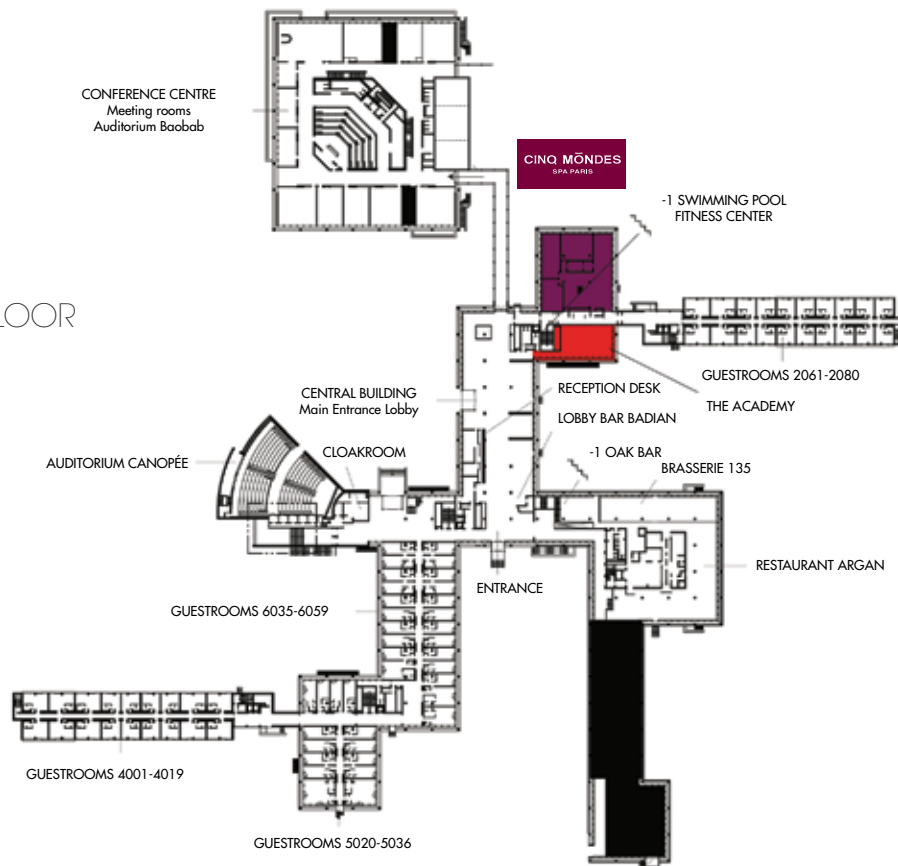

FIRST FLOOR

