

MAIN LEVEL & QUAIL LODGE

1

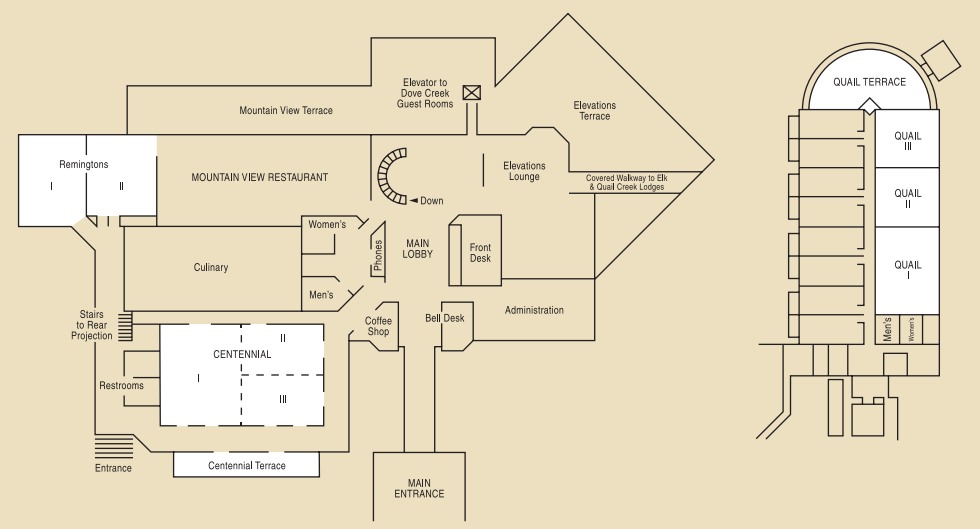

| Specific Rooms | Dimension | Area | Classroom | Theatre | U-Shape | Hollow Square | Reception | Banquet |
|---------------------|-----------|------|-----------|---------|---------|---------------|-----------|---------|
| Centennial Room | 92' x 53' | 4876 | 256 | 360 | 108 | 136 | 500 | 350 |
| Centennial I | 46' x 53' | 2438 | 125 | 170 | 54 | 72 | 200 | 180 |
| Centennial II | 46' x 26' | 1196 | 48 | 108 | 32 | 30 | 125 | 80 |
| Centennial III | 46' x 26' | 1196 | 48 | 108 | 32 | 30 | 125 | 80 |
| Centennial II & III | 46' x 53' | 2438 | 125 | 170 | 54 | 72 | 200 | 180 |
| Centennial Terrace | 19' x 70' | 1330 | N/A | 150 | N/A | N/A | 142 | 95 |
| Remingtons | 82' x 43' | 3526 | 200 | 325 | N/A | N/A | 300 | 240 |
| Remington I | 40' x 43' | 1720 | 68 | 100 | 39 | 52 | 150 | 100 |
| Remington II | 42' x 43' | 1806 | 70 | 100 | 35 | 36 | 150 | 110 |
| Quail I | 41' x 26' | 1066 | 48 | 80 | 35 | 40 | 75 | 60 |
| Quail II | 26' x 26' | 676 | 24 | 55 | 23 | 28 | 50 | 30 |
| Quail III | 26' x 26' | 676 | 24 | 55 | 23 | 28 | 50 | 30 |
| Quail Terrace | 28' x 50' | 1400 | N/A | 120 | N/A | N/A | 125 | 80 |

CONFERENCE LEVEL

2

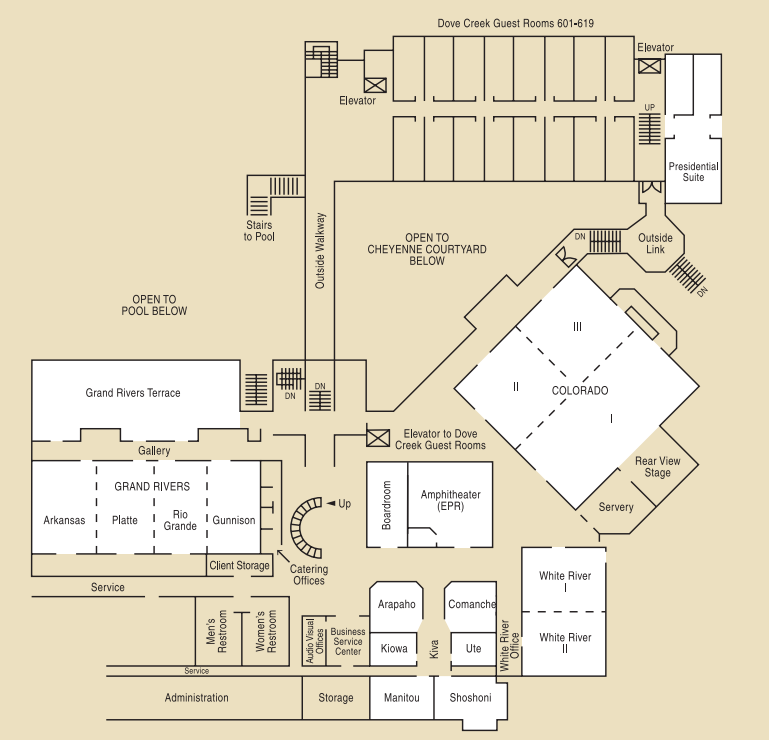

| Specific Rooms | Dimension | Area | Classroom | Theatre | U-Shape | Hollow Square | Reception | Banquet |
|-------------------------------|------------|------|-----------|---------|---------|---------------|-----------|---------|
| Colorado | 80' x 80' | 6400 | 400 | 600 | 108 | 144 | 600 | 500 |
| Colorado I | 40' x 80' | 3200 | 180 | 288 | 90 | 108 | 300 | 260 |
| Colorado II | 40' x 40' | 1600 | 90 | 96 | 39 | 44 | 150 | 90 |
| Colorado III | 40' x 40' | 1600 | 90 | 96 | 39 | 44 | 150 | 90 |
| Colorado II & III | 40' x 80' | 3200 | 180 | 180 | 90 | 108 | 300 | 260 |
| Grand Rivers Room | 107' x 43' | 4601 | 288 | 368 | 102 | 120 | 400 | 280 |
| Arkansas | 29' x 43' | 1247 | 61 | 78 | 35 | 40 | 125 | 80 |
| Platte | 29' x 43' | 1247 | 61 | 78 | 35 | 40 | 125 | 80 |
| Rio Grande | 24' x 43' | 1032 | 45 | 65 | 32 | 36 | 90 | 60 |
| Gunnison | 25' x 43' | 1075 | 45 | 65 | 32 | 36 | 90 | 60 |
| Grand Rivers Terrace | 81' x 36' | 2916 | N/A | 180 | N/A | N/A | 175 | 140 |
| Arkansas & Platte | 58' x 43' | 2494 | 126 | 208 | 57 | 57 | 225 | 160 |
| Rio Grande & Gunnison | 49' x 43' | 2107 | 108 | 144 | 45 | 52 | 200 | 170 |
| Arkansas, Platte & Rio Grande | 82' x 43' | 3526 | 216 | 336 | 84 | 96 | 325 | 240 |
| Arapaho or Comanche | 19' x 24' | 456 | 20 | 28 | 12 | 16 | 40 | 20 |
| Kiowa or Ute | 17' x 19' | 323 | 18 | 27 | 10 | 14 | 30 | 10 |
| Manitou or Shoshoni | 19' x 29' | 551 | 36 | 45 | 22 | 26 | 50 | 40 |
| Boardroom | 37' x 19' | 703 | N/A | N/A | N/A | N/A | N/A | 18 |
| Amphitheater (EPR) | 40' x 40' | 1600 | 100 | N/A | N/A | N/A | N/A | N/A |
| White River | 60' x 40' | 2400 | 162 | 216 | 57 | 70 | 200 | 180 |
| White River I | 30' x 40' | 1200 | 55 | 78 | 35 | 40 | 125 | 90 |
| White River II | 30' x 40' | 1200 | 55 | 78 | 35 | 40 | 125 | 90 |

COURTYARD LEVEL

3

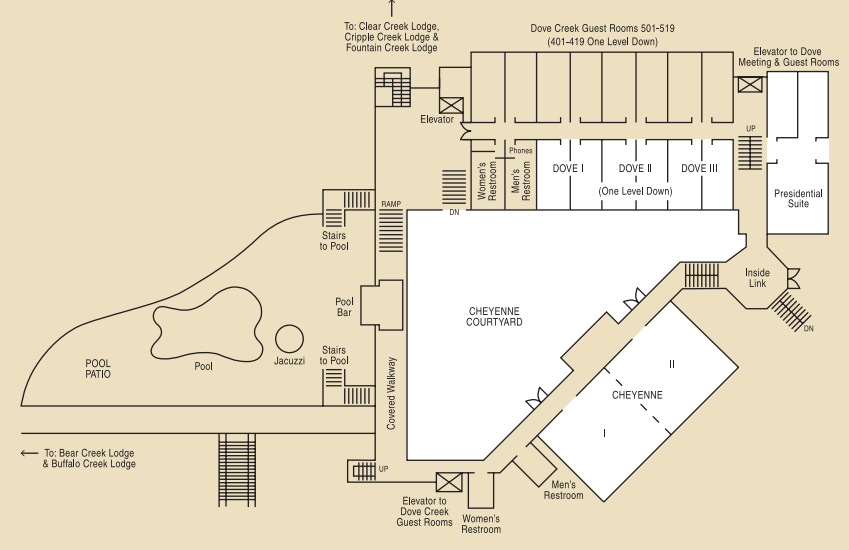

| Specific Rooms | Dimension | Area | Classroom | Theatre | U-Shape | Hollow Square | Reception | Banquet |
|--------------------|-----------|------|-----------|---------|---------|---------------|-----------|---------|
| Dove I | 27' x 27' | 729 | 33 | 50 | 21 | 27 | 65 | 40 |
| Dove II | 27' x 27' | 729 | 33 | 50 | 21 | 27 | 65 | 40 |
| Dove III | 27' x 27' | 729 | 33 | 50 | 21 | 27 | 65 | 40 |
| Cheyenne Room | 40' x 78' | 3120 | 160 | 324 | 67 | 80 | 285 | 180 |
| Cheyenne I | 40' x 38' | 1520 | 72 | 96 | 39 | 44 | 150 | 90 |
| Cheyenne II | 40' x 40' | 1600 | 72 | 96 | 39 | 44 | 135 | 90 |
| Cheyenne Courtyard | 70' x 80' | 5600 | N/A | 500 | N/A | N/A | 550 | 420 |