

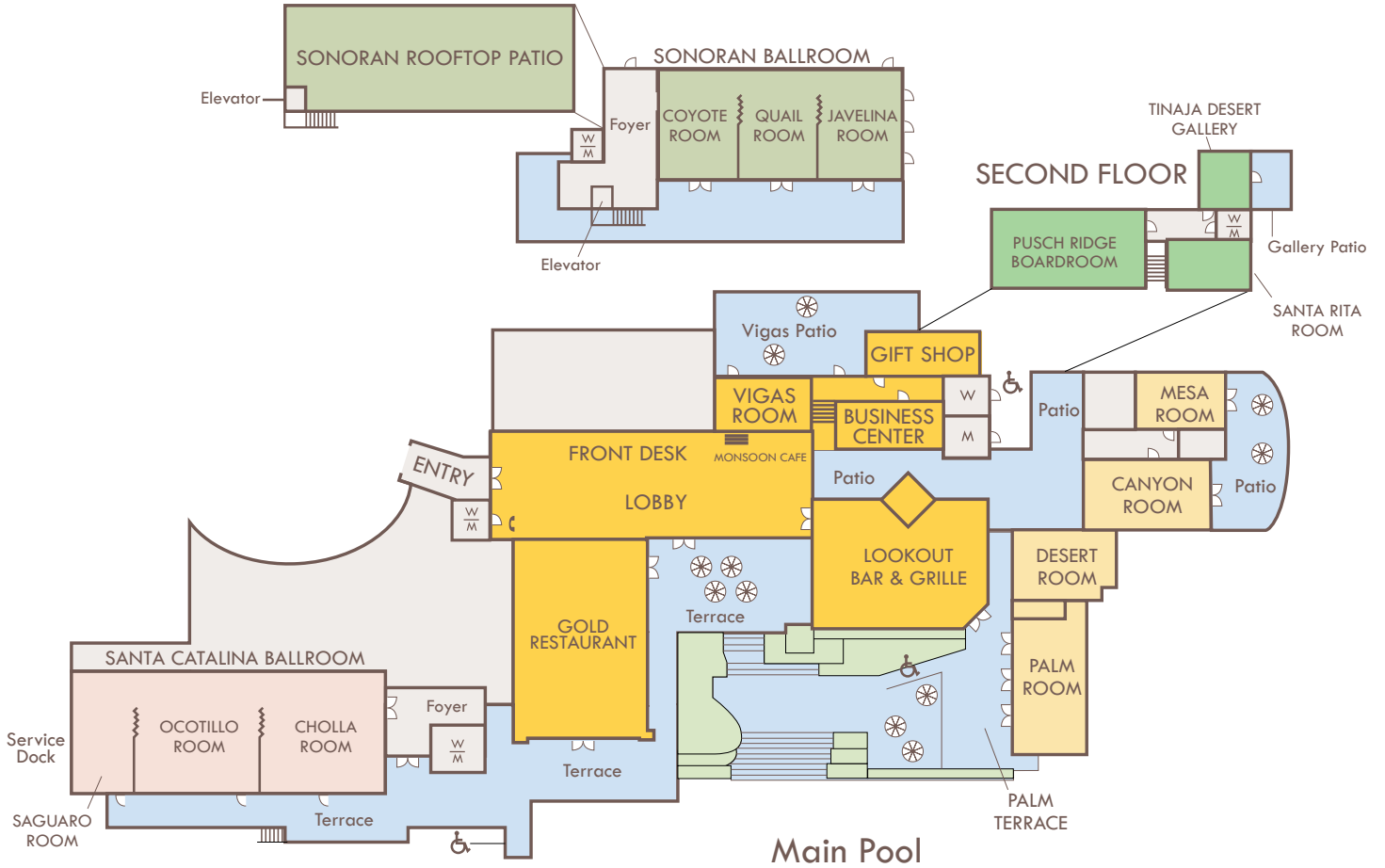

WESTWARD LOOK

WYNDHAM GRAND RESORT & SPA

The Soul of the Southwest



Function Rooms	Dimensions	Area	Ceiling	Conference	U-Shape	Theater	Banquet	Classroom	Reception
Sonoran Ballroom	88 x 49	4,312	16	100	90	450	290	250	450
Coyote Room	29 x 49	1,421	16	48	36	120	90	64	150
Quail Room	30 x 49	1,470	16	50	36	130	90	82	170
Javelina Room	29 x 49	1,421	16	48	24	120	90	64	150
Sonoran Rooftop Patio	84 x 44	3,696				250	200		450
Santa Catalina Ballroom	98 x 37	3,626	15	100	90	320	250	192	400
Cholla Room	40 x 40	1,443	15	50	38	100	80	60	150
Ocotillo Room	40 x 37	1,480	15	52	38	100	80	60	150
Saguaro Room	19 x 37	703	15	28	28	50	40	36	70
Palm Room	22 x 43	946	9	40	35	80	70	48	100
Palm Terrace	33 x 37	1,221				70	70		120
Canyon Room	24 x 42	1,000	12	42	33	80	70	48	100
Mesa Room	18 x 30	540	12	20	20	40	40	27	40
Desert Room	20 x 34	680	8	30	22	50	40	30	50
Pusch Ridge Boardroom	18 x 28	504	9	18					

Follow Us on Twitter at twitter.com/wyndhamwestward | Like Us on Facebook at facebook.com/westwardlookresort