



Wyndham Glenview Suites Hotel has suites for comfort and space for gathering. It's everything you need for a meeting all under one roof. We've got 12,000 square feet of flexible meeting space to seat up to 450 people.

Grand Ballroom:

- Over 5,100 total square feet
- Seats 450
- 14-foot ceilings with crystal chandeliers
- Elegant marble-floored, prefunction area and separate banquet entrance
- Can be divided into six separate salons for break-out sessions

The Garden Atrium

- 7,000 square feet
- Located on the second floor
- Beautifully landscaped for an open-air feeling
- Perfect for corporate luncheons or cocktail receptions

The North Shore Junior Ballroom

- 1,830 total square feet
- Comfortably fits 80 people

Rooms for special meetings

- Executive Boardroom seats 12
- Two 2-bedroom conference suites* for up to 15
- Eight 1-bedroom conference suites* for up to 8

All Meeting Attendees will find their stay so "Suite"

- All suite hotel with separate living rooms and bedrooms
- 253 luxurious suites which include 65 double suites, 186 king suites, a Presidential and an extraordinary Bridal Suite
- Ask about an upgrade to one of our CLEAN AIR Allergy friendly suites
- Complimentary high speed wireless internet access in all guest suites, lobby, restaurant and lounges
- Oversized desk for any size project with Herman Miller Aeron desk chair, providing extra lower back support
- A 32" plasma flatscreen TV with On Demand movies and WEB TV
- Pillow-top mattresses
- Microwave, refrigerator, coffee maker, and wet bar in each suite
- Cordless, two-line telephone with voice mail, speaker phone, and dataport
- Indoor pool, whirlpool, and dry sauna
- Fully equipped fitness center
- Contemporary American cuisine served at Porter's Bistro & Bar
- Wyndham's signature Fields and Sun Breakfast served every morning in the Garden Atrium
- Complimentary weekday newspaper delivered to your door
- Conveniences of home supplied in every room including MP3 alarm clock/radio, hair dryer, iron, and ironing board
- A 24-hour Business Center
- Valet or coin laundry
- Convenient self-parking
- On-premise safe-deposit boxes
- On-premise ATM
- Complimentary shuttle to entertainment venues and business centers within a 5-mile radius during normal business hours

* ALL CONFERENCE SUITES SUITED FOR PRIVATE DINING.



Partner with Wyndham by becoming a **Wyndham ByRequest** member and gain special **Wyndham Rewards** benefits nationwide. Meeting planners may also be eligible for **Wyndham Event Rewards**. To find out more, visit Wyndham.com.

Central location that's near it all

The Wyndham Glenview Suites is surrounded by premier Chicago destinations. We're easy to get to with our location only seven miles north of Chicago O'Hare International Airport. The hotel sits across from the Grove, a vast natural forest preserve, and is surrounded by major business centers.

If shopping is a priority, we're a quick drive to world-class centers such as downtown Chicago's Magnificent Mile, Old Orchard Shopping Mall, Woodfield Mall, Northbrook Court, The Glen Town Center, and Gurnee Mills Outlet Mall. For unique boutique shopping, we're right down the way from historic Long Grove.

For golf-lovers, our hotel is the Official Hotel of the Bank of America Open of the Nationwide PGA Tour. The hotel also allows easy access to the Ravinia Summer Concerts, Taste of Chicago, Arlington Park thoroughbred racing, Six Flags Great America & Hurricane Harbor Water Park, Chicago Botanic Garden, and all of the other exciting sites Chicago is known for.

Meeting Space Capacity Chart*

Name of Room	Dimensions	Ceiling Height	Square Feet	Reception	Banquet	Theater	Classroom	Conference	U-Shape	Crescent Rounds
Grand Ballroom	108' x 48'	14'	5,184	400	350	450	240	120	140	224
A	27' x 24'	14'	648	35	40	50	30	18	18	28
B	27' x 24'	14'	648	35	40	50	30	18	18	28
C	48' x 27'	14'	1,296	75	80	100	60	35	35	56
D	48' x 27'	14'	1,296	75	80	100	60	35	35	56
E	27' x 24'	14'	648	35	40	50	30	18	18	28
F	27' x 24'	14'	648	35	40	50	30	18	18	28
North Shore Boardroom 1	30' x 61'	14'2"	1,830	120	110	110	80	-	45	77
	26' x 14'	10'	364	-	-	-	-	12	-	-

* Our meeting room capacities have been calculated using the Meeting Professionals International Comfort Calculator.

CONFERENCE/MEETING ROOMS

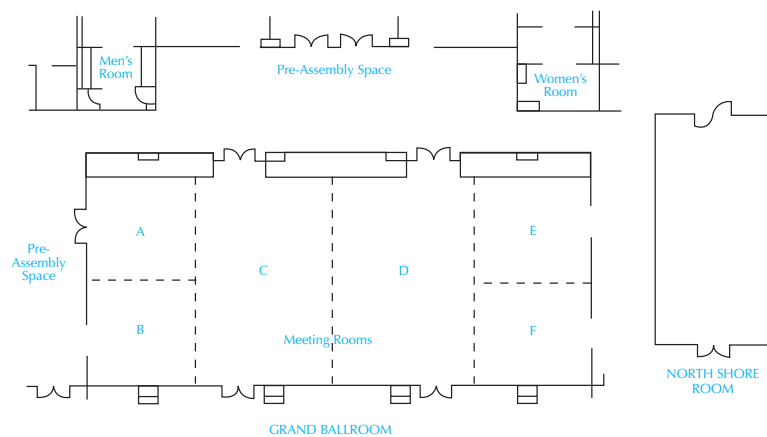

For individual reservations, call 1-800-WYNDHAM.

Call our Sales Professionals at (847) 803-9800.